

A-max 32 $\varnothing 32$ mm, graphite brushes, 20 watt

Kabel AWG 22/7
 cable UL Style 1061
 ⊕ Kabel rot
 cable red

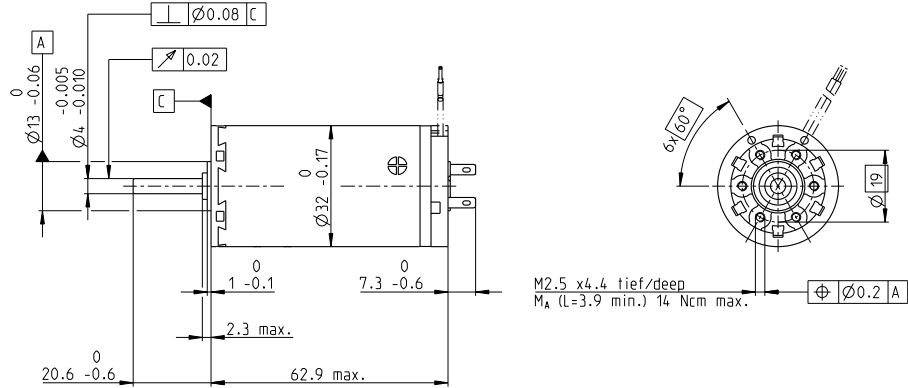
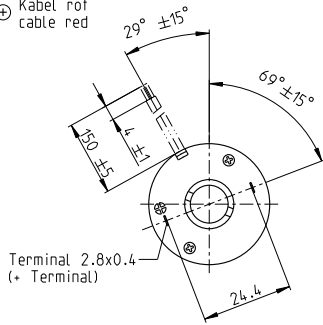

M 1:2

- Stock program
- Standard program
- Special program (on request)

Part Numbers

with terminals	236659	236660	236661	236662	236663	236664	236665
with cables	353230	353231	353232	262500	341970	353233	353234

Motor Data									
Values at nominal voltage									
		6	9	12	24	30	36	42	
1 Nominal voltage	V	6	9	12	24	30	36	42	
2 No load speed	rpm	4880	5000	4670	6460	6160	5860	5650	
3 No load current	mA	123	84.2	58.2	42.8	32.3	25.3	20.8	
4 Nominal speed	rpm	3400	3480	3170	5060	4740	4430	4210	
5 Nominal torque (max. continuous torque)	mNm	44.5	43.1	44	45.5	45.1	45.4	45	
6 Nominal current (max. continuous current)	A	3.96	2.62	1.87	1.33	1.01	0.804	0.659	
7 Stall torque	mNm	153	146	140	212	197	189	178	
8 Stall current	A	13.2	8.57	5.77	6.02	4.27	3.24	2.54	
9 Max. efficiency	%	80	80	80	84	83	83	83	
Characteristics									
10 Terminal resistance	Ω	0.454	1.05	2.08	3.99	7.02	11.1	16.6	
11 Terminal inductance	mH	0.06	0.13	0.264	0.556	0.954	1.52	2.22	
12 Torque constant	mNm/A	11.6	17	24.3	35.2	46.1	58.2	70.4	
13 Speed constant	rpm/V	825	562	394	271	207	164	136	
14 Speed/torque gradient	rpm/mNm	32.4	34.8	33.8	30.8	31.6	31.3	31.9	
15 Mechanical time constant	ms	15	14.9	14.7	14.6	14.6	14.6	14.7	
16 Rotor inertia	gcm ²	44.2	40.8	41.7	45.3	44.2	44.6	43.8	

Specifications

Thermal data

17 Thermal resistance housing-ambient	7.5 K/W
18 Thermal resistance winding-housing	2.1 K/W
19 Thermal time constant winding	17.8 s
20 Thermal time constant motor	521 s
21 Ambient temperature	-20...+85°C
22 Max. winding temperature	+125°C

Mechanical data (ball bearings)

23 Max. speed	6000 rpm
24 Axial play	0.12 - 0.22 mm
25 Radial play	0.025 mm
26 Max. axial load (dynamic)	7.6 N
27 Max. force for press fits (static)	110 N
28 Max. radial load, 5 mm from flange	32 N

Mechanical data (sleeve bearings)

23 Max. speed	6000 rpm
24 Axial play	0.12 - 0.22 mm
25 Radial play	0.012 mm
26 Max. axial load (dynamic)	5 N
27 Max. force for press fits (static)	110 N
28 Max. radial load, 5 mm from flange	10.5 N

Other specifications

29 Number of pole pairs	1
30 Number of commutator segments	13
31 Weight of motor	240 g

Values listed in the table are nominal.
 Explanation of the figures on page 82.

Option

Sleeve bearings in place of ball bearings

Operating Range

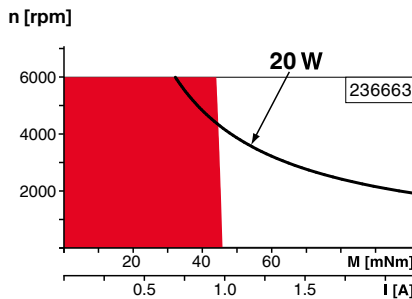

Comments

- Continuous operation**
 In observation of above listed thermal resistance (lines 17 and 18) the maximum permissible winding temperature will be reached during continuous operation at 25°C ambient.
 = Thermal limit.
- Short term operation**
 The motor may be briefly overloaded (recurring).
- Assigned power rating**

maxon Modular System

Details on catalog page 38

- Planetary Gearhead**
 $\varnothing 32$ mm
 0.75 - 6.0 Nm
 Page 392-394/396-398
- Spur Gearhead**
 $\varnothing 38$ mm
 0.1 - 0.6 Nm
 Page 404
- Screw Drive**
 $\varnothing 32$ mm
 Page 426-433

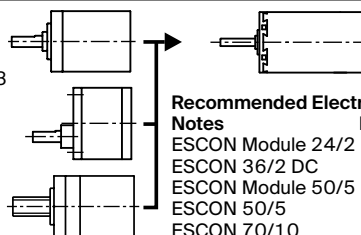

Recommended Electronics:

Notes	Page 38
ESCON Module 24/2	500
ESCON 36/2 DC	500
ESCON Module 50/5	501
ESCON 50/5	503
ESCON 70/10	503