

EC 19 Ø19 mm, brushless, 60 Watt

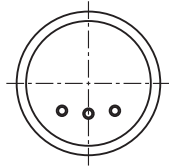

Lage des Kabelabganges zum Befestigungsbohrbild ± 25°

alignment of cables to mounting holes ± 25°

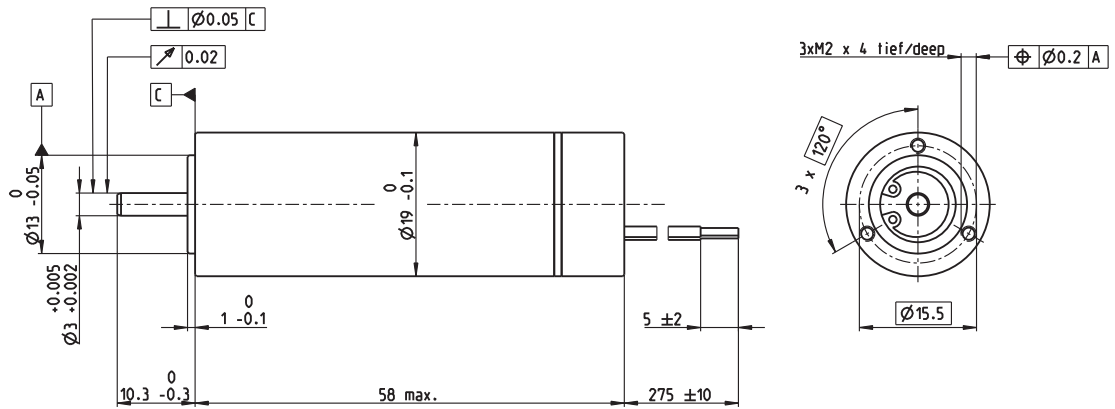

M 1:1

- Stock program
- Standard program
- Special program (on request)

Part Numbers				
sensorless	475529	475530	474510	477254

Motor Data (provisional)					
Values at nominal voltage					
1 Nominal voltage	V	18	24	30	36
2 No load speed	rpm	67000	69500	65200	67100
3 No load current	mA	406	324	232	203
4 Nominal speed	rpm	64200	67000	62600	64500
5 Nominal torque (max. continuous torque)	mNm	8.71	8.3	9.15	8.28
6 Nominal current (max. continuous current)	A	3.77	2.82	2.29	1.8
7 Stall torque	mNm	279	318	312	295
8 Stall current	A	109	97	71.3	57.8
9 Max. efficiency	%	88	89	89	89
Characteristics					
10 Terminal resistance phase to phase	Ω	0.165	0.247	0.421	0.623
11 Terminal inductance phase to phase	mH	0.018	0.03	0.053	0.073
12 Torque constant	mNm/A	2.55	3.28	4.37	5.1
13 Speed constant	rpm/V	3740	2910	2180	1870
14 Speed/torque gradient	rpm/mNm	242	220	210	229
15 Mechanical time constant	ms	4.15	3.77	3.61	3.93
16 Rotor inertia	gcm ²	1.64	1.64	1.64	1.64

Specifications	
Thermal data	
17 Thermal resistance housing-ambient	14.0 K/W
18 Thermal resistance winding-housing	0.808 K/W
19 Thermal time constant winding	2.67 s
20 Thermal time constant motor	557 s
21 Ambient temperature	-20...+100°C
22 Max. winding temperature	120°C
Mechanical data (preloaded ball bearings)	
23 Max. speed	80000 rpm
24 Axial play at axial load < 3 N	0 mm
> 3 N	max. 0.1 mm
25 Radial play	preloaded
26 Max. axial load (dynamic)	3.1 N
27 Max. force for press fits (static) (static, shaft supported)	21 N
28 Max. radial load, 5 mm from flange	1400 N
Other specifications	
29 Number of pole pairs	1
30 Number of phases	3
31 Weight of motor	98 g

Values listed in the table are nominal.

Connection motor (Cable AWG 22)
 red Motor winding 1
 black Motor winding 2
 white Motor winding 3

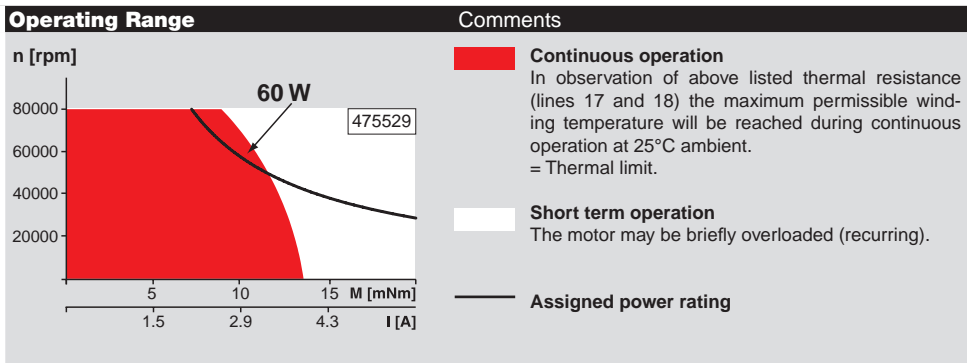

maxon Modular System Overview on page 20–25

Recommended Electronics:
 Notes Page 24
 ESCON Mod. 50/4 EC-S 379