

GPX 10 \varnothing 10 mm, planetary gearhead



GPX

Key Data		A Standard Version	
Max. transmittable power	W	1.6	
Max. continuous torque	Nm	0.15	
Max. continuous input speed	rpm	12000	
Ambient temperature	°C	-40 ... +80	
Bearing at output		Ball bearing	

Operating Range (output shaft) A Standard Version

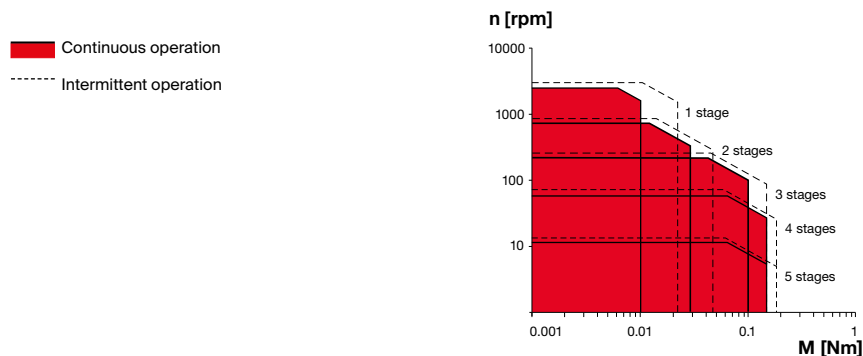

Specifications A Standard Version

		1	2	3	4	5
Number of stages		1	2	3	4	5
Max. transmittable power (continuous)	W	1.6	1.2	1.0	0.40	0.10
Max. transmittable power (intermittent)	W	2.0	1.5	1.3	0.50	0.13
Max. continuous torque	Nm	0.01	0.03	0.10	0.15	0.15
Max. intermittent torque	Nm	0.02	0.05	0.15	0.20	0.20
Max. continuous input speed	rpm	12000	12000	12000	12000	12000
Max. intermittent input speed	rpm	15000	15000	15000	15000	15000
Max. efficiency	%	90	81	73	65	59
Average backlash no load	°	1.5	1.8	2.0	2.2	2.5
Max. axial load (dynamic)	N	5	5	5	5	5
Max. radial load, 5 mm from flange	N	5	10	15	20	25
Gearhead length L1 ¹	mm	9.9	13.4	16.6	19.8	23.0
Weight	g	6.7	7.2	7.7	8.2	8.7

Configuration A Standard Version

		1	2	3	4	5
Number of stages		1	2	3	4	5
Reduction	X:1	4	16	64	256	1024
Absolute reduction: (see online)						

Version	Standard
Flange	Standard flange
Shaft	Length/flat face

maxon Modular System Page Dimensions M 2:1

maxon DC motor	Nº of stages [opt.]	Page
DCX 10 S	1-5	87
DCX 10 L	1-5	88

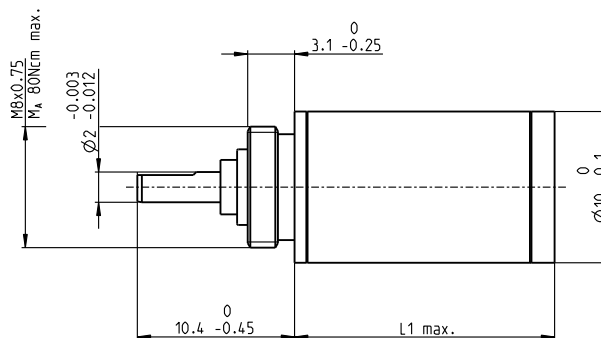

¹This length may vary depending on the configuration and choice of motor. The effective length is calculated at the end of the configuration process.

gpx.maxongroup.com