

# GPX 12 $\varnothing$ 12 mm, planetary gearhead

GPX

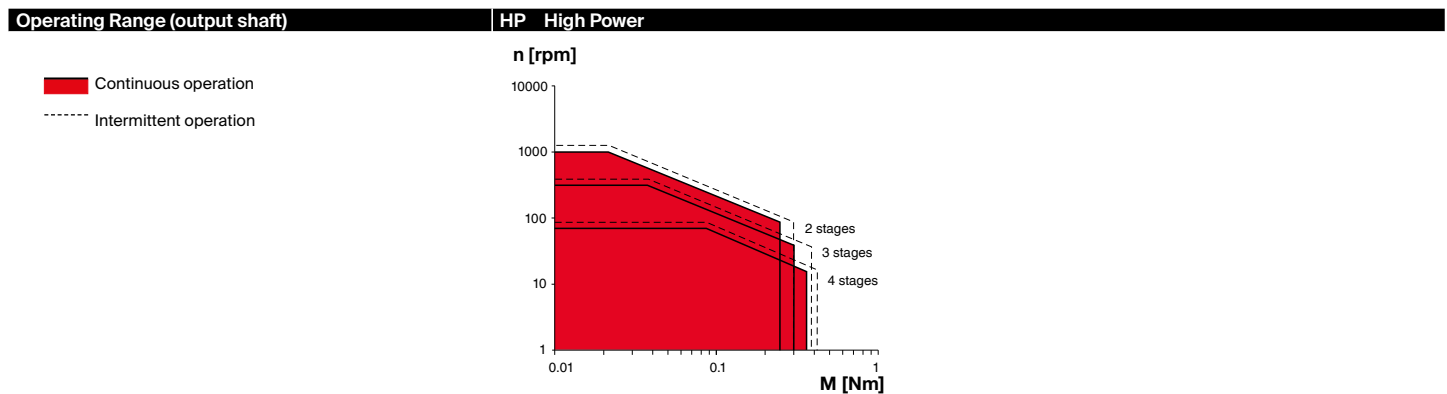

Key Data		HP High Power
Max. transmittable power	W	2.2
Max. continuous torque	Nm	0.35
Max. continuous input speed	rpm	16000
Ambient temperature	°C	-40 ... +100
Bearing at output		Ball bearing



Specifications		HP High Power		
		2	3	4
Number of stages		2	3	4
Max. transmittable power (continuous)	W	2.2	1.10	0.60
Max. transmittable power (intermittent)	W	2.80	1.40	0.80
Max. continuous torque	Nm	0.25	0.30	0.35
Max. intermittent torque	Nm	0.30	0.38	0.41
Max. continuous input speed	rpm	16000	16000	16000
Max. intermittent input speed	rpm	20000	20000	20000
Max. efficiency	%	75	65	55
Average backlash no load	°	1.5	1.8	2.1
Max. axial load (dynamic)	N	20	20	20
Max. radial load, 5 mm from flange	N	45	60	60
Gearhead length L <sup>1</sup>	mm	23.4	28.1	33.1
Weight	g	16	19	21

Configuration		HP High Power		
		2	3	4
Number of stages		2	3	4
Reduction	X:1	16, 21, 26, 28, 35	62, 83, 103, 111, 138, 150, 172, 186, 231	243, 326, 406, 439, 546, 590, 679, 734, 794, 913, 987, 1135, 1227, 1526
Absolute reduction: (see online)				
Version		Standard/ceramic version/noise reduced/backlash reduced/high power		
Flange		Standard flange		
Shaft		Length/flat face		

maxon Modular System		Page	Dimensions	M 2:1
----------------------	--	------	------------	-------

maxon DC motor	N° of stages [opt.]		
DCX 12 S	2-4	89	
DCX 12 L	2-4	90	

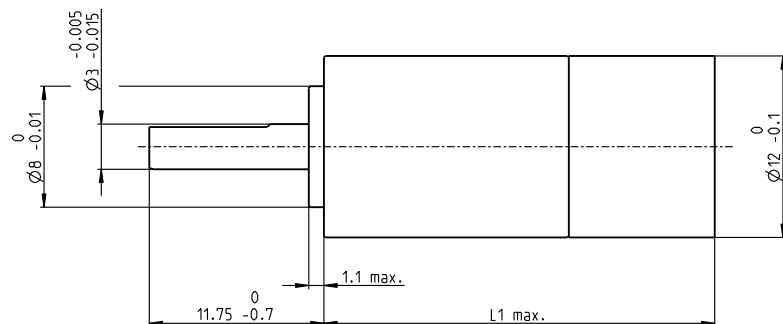

<sup>1</sup>This length may vary depending on the configuration and choice of motor. The effective length is calculated at the end of the configuration process.

[gpx.maxongroup.com](http://gpx.maxongroup.com)